

NOTE: CHAINAGES SHOWN ARE ALONG W. R. OF STURGEON RD

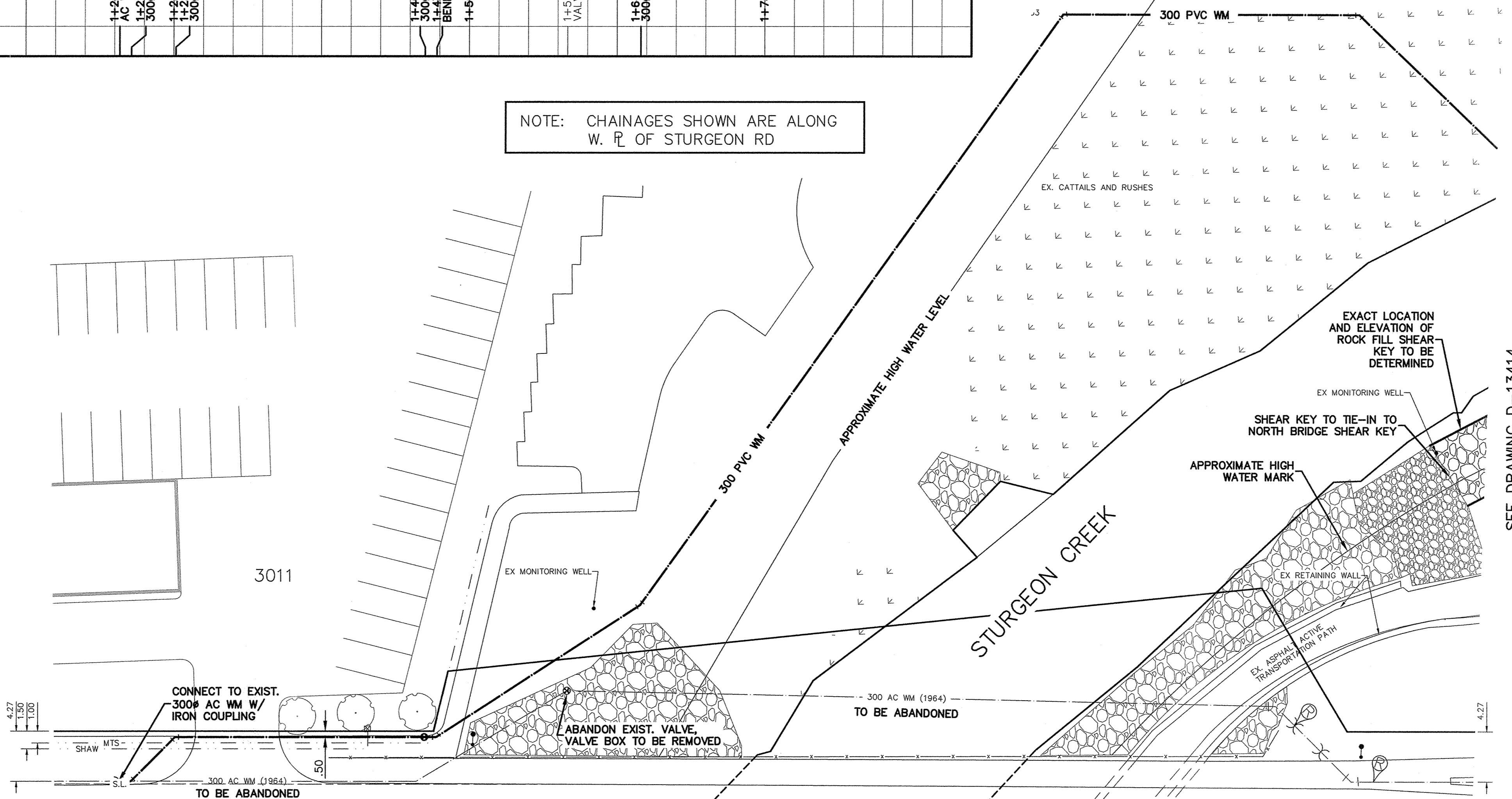

NOTE: ALL VALVES TO BE INSTALLED COUNTERCLOCKWISE TO CLOSE

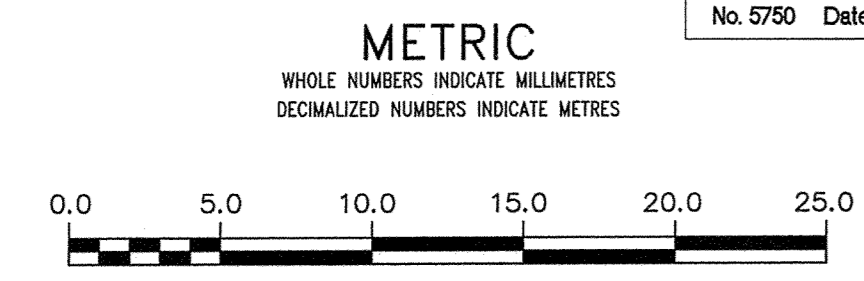
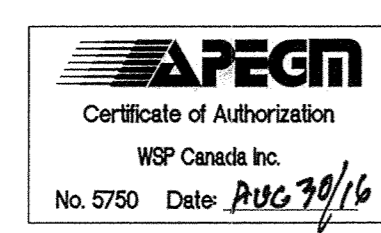

WARNING
IF POWER EQUIPMENT OR EXPLOSIVES ARE TO BE USED FOR EXCAVATION ON THIS PROJECT THE CONTRACTOR MUST:
1) NOTIFY THE GAS COMPANY OF THE PROPOSED LOCATION OF EXCAVATION.
2) TAKE PRECAUTION TO AVOID DAMAGE TO GAS COMPANY INSTALLATIONS.
SEE PROVINCIAL REGULATION 210/72 FOR DETAILS

LOCATION APPROVED UNDERGROUND STRUCTURES
SHPV. U/G STRUCTURES COMMITTEE DATE
NOTE:
LOCATION OF UNDERGROUND STRUCTURES AS SHOWN ARE BASED ON THE BEST INFORMATION AVAILABLE BUT NO GUARANTEE IS GIVEN THAT ALL EXISTING UTILITIES ARE SHOWN OR THAT THE GIVEN LOCATIONS ARE EXACT. CONFIRMATION OF EXISTENCE AND EXACT LOCATION OF ALL SERVICES MUST BE OBTAINED FROM THE INDIVIDUAL UTILITIES BEFORE PROCEEDING WITH CONSTRUCTION.

B.M.	CWM 39-044				
ELEV.	233.848				
CONSTRUCTION COMPLETION DATE:	---				
NO.	REVISIONS	DATE	BY		
3	BID OPPORTUNITY 781-2016	08/2016	R.H.		
2	BID OPPORTUNITY 152-2016	02/2016	K.G.		
1	DESIGN REVIEW BY W&W	02/2015	K.G.		

WSP 1600 BUFFALO PLACE WINNIPEG, MB, R3T 6B8 PHONE: 204-477-6850 FAX: 204-474-2864 WWW.WSPGROUP.COM

DESIGNED BY: K.G. CHECKED BY: S.M.
DRAWN BY: K.G. APPROVED BY: I.McK.
SCALE: HORIZONTAL 1:250 VERTICAL 1:50
DATE: 2016 08 30

ENGINEER'S SEAL
PROVINCE OF MANITOBA
McKINNON
CONSULTANT DRAWING NUMBER
151-00351-00-04

THE CITY OF WINNIPEG
WATER AND WASTE DEPARTMENT
ENGINEERING DIVISION

2015 WATERMAIN RENEWALS

STURGEON ROAD
34.8M NNL OF PORTAGE AVE TO
141.4M NNL OF PORTAGE AVE

SHEET 4 OF 5
CITY DRAWING NUMBER
D-13413